

Special Needs Series

SUBMITTAL DATA

FRONT VIEW

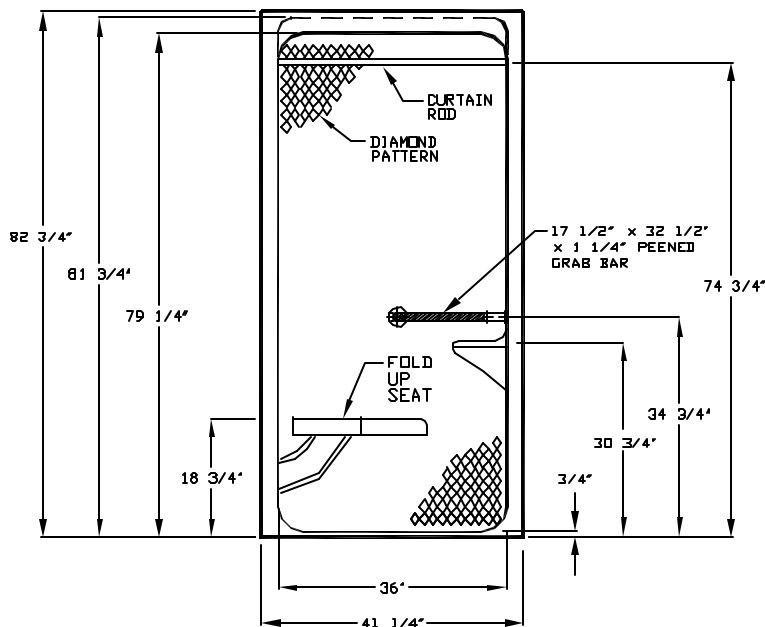

SIDE VIEW

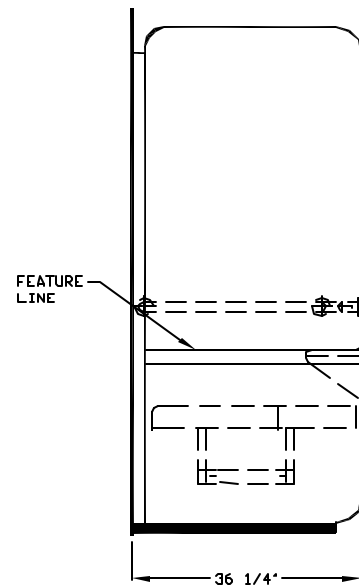

Transfer Shower Stall

This shower enclosure shall be Aquarius Model S 4136 BF acrylic. The unit shall be molded from a single sheet of acrylic so as not to have any seams or joints. It shall meet ANSI A117.1 and ANSI 124.2, shall have the backside fire rating of "A" and a flame spread of less than 25, shall be designed to meet ADA, FHA, HUD, BOCA, NAHB, LPC and shall meet the requirements of most state and national standards on design for the disabled including Southern Building Code and Massachusetts Code. The unit shall have inside dimensions of 36" x 36" x 80 1/2" and the outside dimensions of 41 1/4" x 36 1/4" x 82 3/4". The unit shall have a 3/4" threshold.

The enclosure shall be equipped with the following factory installed accessories:

- 1) one 17 1/2" x 32 1/2" x 1 1/4" L-shaped peened grab bar with 1 1/2" clearance statute, mounted with stainless steel bolts secured from the rear with 3" x 3", 11 gauge metal backing plates,
- 2) 1" diameter 20 gauge stainless steel curtain rod, 3) self caulking brass drain with chrome strainer, 4) fold up seat.

Available options: 1) dome light, 2) hand held shower set (includes: hand set, 60" flex hose, swivel connector, vacuum breaker, brass nipple, lock nut and shower wall outlet), 3) pressure balance valve, 4) green anti-bacterial shower curtain with hooks, 5) white shower curtain and hooks.

NOTE: EACH SIDE WALL CONTAINS A FEATURE LINE FROM 30" TO 32" HORIZONTAL THIS FEATURE LINE OFFSETS 3/8" FROM THE SIDE WALL IN PLUMBING PLANS ENSURE THIS WILL NOT INTERFERE WITH VALVE AND PLUMBING PLACEMENT.

TOP VIEW

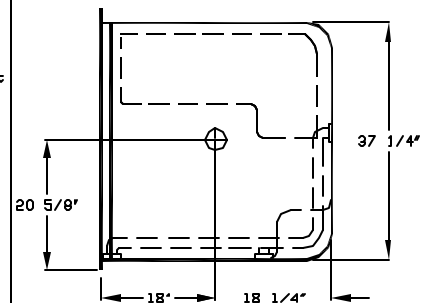

DUE TO THE NATURE OF THE MATERIALS INVOLVED, UNIT DIMENSIONS MAY VARY $\pm 1/2$ INCH.

Job Name:

AQUARIUS

Model No.: S4136BF WITH A MODIFIED WITH A 3/4" THRESHOLD & 1 1/4" O.D. PEENED L-SHAPED GRAB BAR

Drawing#: S413626

Approved by:

Date Approved:

Date: 7-17-96 Revised: 2-16-04

Rep.:

Wholesaler:

Quote No.:

PRAXIS INDUSTRIES, LLC.
ROUTE 1, BOX 46D - SAVANNAH, TN 38372
1 (800) 443-7269 - FAX (731) 925-4290